

2023 RHODE ISLAND RV Show

GENERAL INFORMATION

CHECK-IN:

Please check-in at the show office located in the lobby entrance of the exhibit hall. Exhibitor credentials will be issued when you check-in at that show office.

You will also get your booth assignments onsite as well. For ordering purposes please use your company name on all forms so that your services for your booth will be correct

Any and all questions contact

Rob Lynch at 941-780-0538 or email at roblynchshows@gmail.com

LOCATION: RHODE ISLAND Convention Center
One Sabin Street
Providence, RI. 02903
401-458-5000

OPEN:

| | |
|------------------------|----------|
| Friday, February 10, | 12-7pm |
| Saturday, February 11, | 9am-7pm |
| Sunday, February 12, | 10am-5pm |

ADMISSION:

\$12.00
Kids Under 16 are FREE

PARKING: Onsite Parking- at prevailing rates
Exhibitors will have a limited number of parking passes.

FLOORPLAN:

Official Exhibitor Floorplan can be viewed on the show website **EXHIBITOR INFO** tab.

ELECTRICITY & INTERNET:

Electric and Internet may be ordered off of the show website **EXHIBITOR INFO** tab.

NAME BADGES:

Official Name Badges can be ordered off of the show website **EXHIBITOR INFO** tab.

FIRE REGULATIONS

MOTORIZED and TOWABLE DISPLAY UNITS:

Vehicles are allowed as part of your display with the following requirements met:

- Must fit completely inside booth dimensions – including mirrors, door steps, bumpers, hitches etc.
- Gas tank level 1/4 of a tank or less
- Gas tank 'lid' taped – sealed (please bring duct tape)
- Battery disconnected (please bring tools)
- No Propane

PRE AND POST SHOW UNIT STAGING:

TWIN RIVER CASINO

Monday, February 6 through Thursday, February 9

Sunday, February 12 through Tuesday, February 14

SEE ATTACHED MAP FOR LOCATION

MOVE-IN: ONE Forklifts with tools will be provided FREE for your use to set units

Thursday, February 9- **7am to 6pm**

7AM-
PETES
Campers Inn

10am
T-Mobile

12PM
BRADS TRAILERS
10 x 10 **Vendor Booths**

3PM
LONGVEIW

Friday, February 10- **8am to 11am**

10 x 10 **Vendor Booths**

MOVE-OUT

Sunday, February 27

Everything must be removed from inside the center by Midnight

***PLEASE DO NOT** start tearing down until we have announced over the PA system that the show is officially closed. We cannot allow you to carry anything out of the building before said announcement.

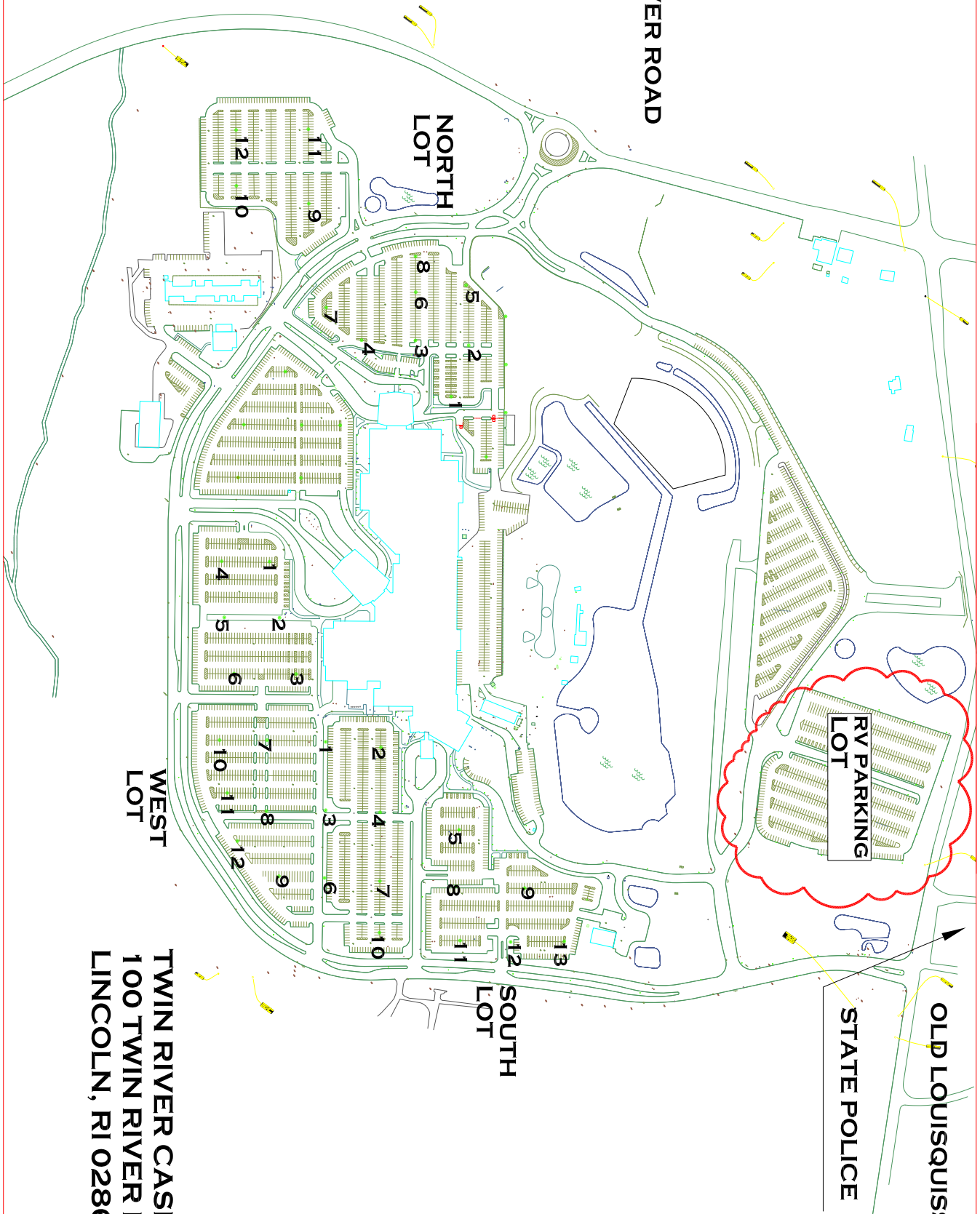

TWIN RIVER ROAD

NORTH LOT

RV PARKING LOT

STATE POLICE

OLD LOUISQUISSET PIKE

WEST LOT

SOUTH LOT

**TWIN RIVER CASINO
100 TWIN RIVER ROAD
LINCOLN, RI 02865**